

SCHEDULE 'A' to the COMPREHENSIVE ZONING BY-LAW for the TOWNSHIP OF LAURENTIAN VALLEY

PEMBROKE TOWNSHIP INSET SCHEDULES



This is Schedule 'A-16' through 'A-19' to the Comprehensive Zoning By-Law Passed the _____ day of _____, 200____
 Signatures of the Signing Officers:
 Mayor _____ Clerk _____

Schedule A-18

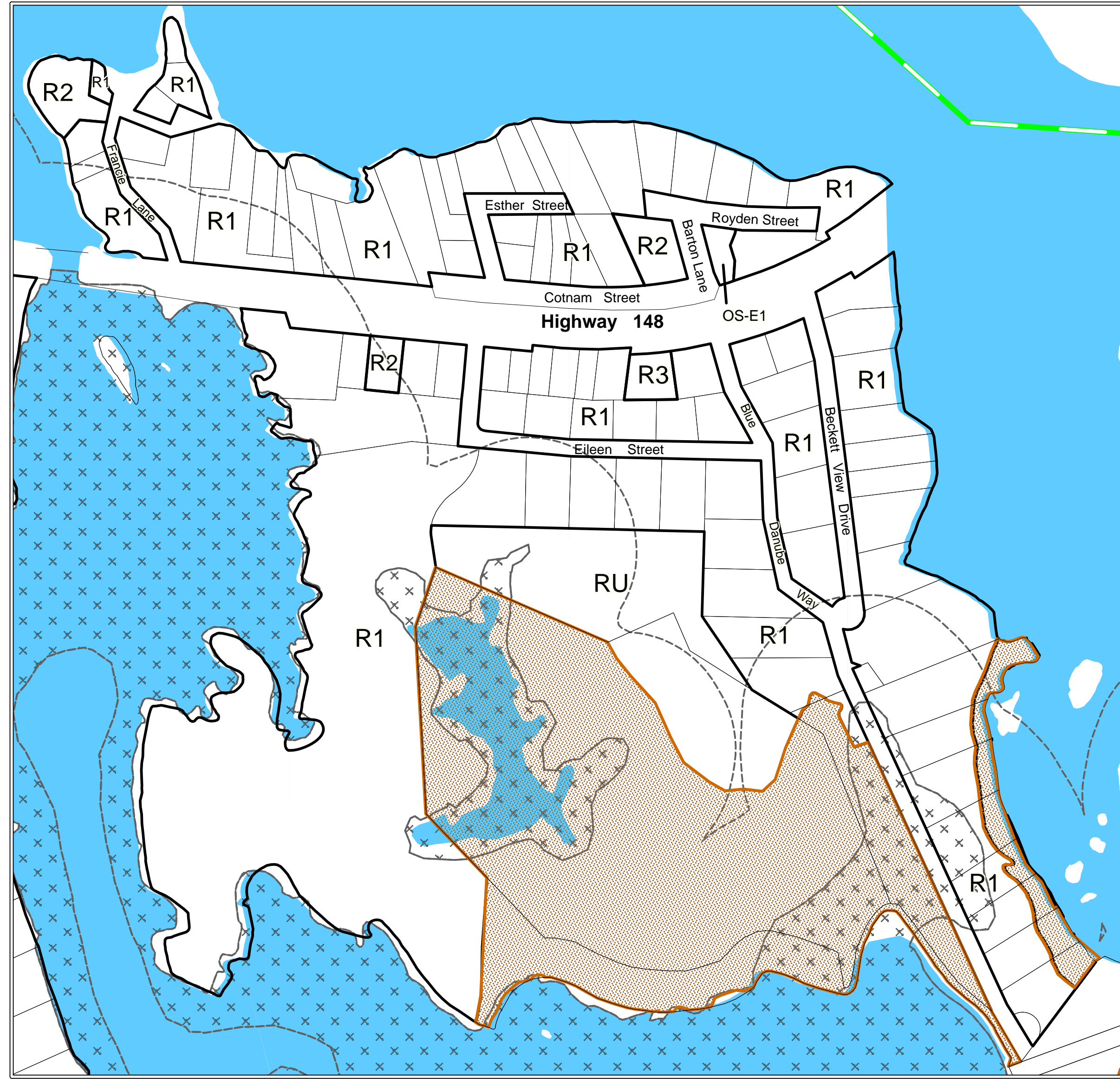

Schedule A-17

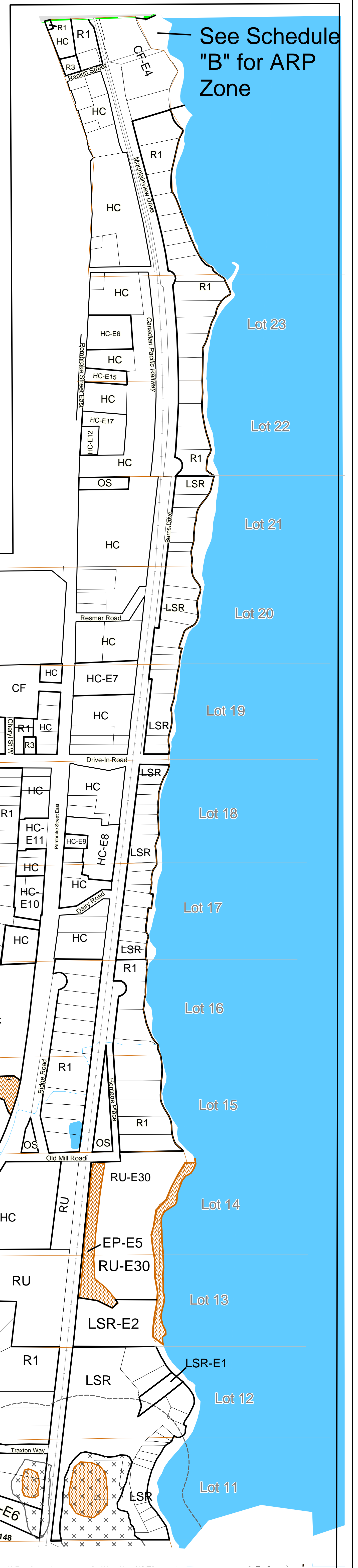

Schedule A-16

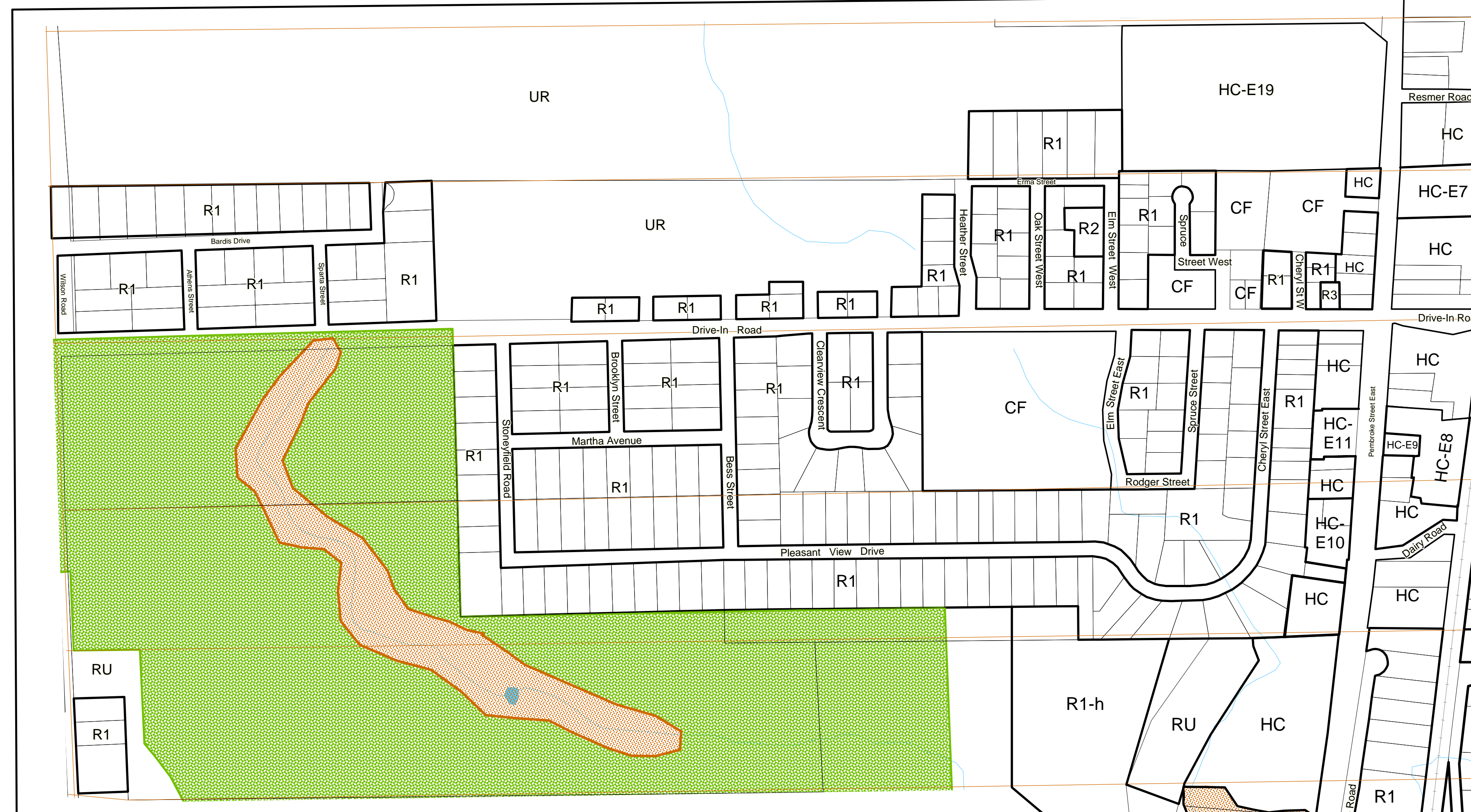
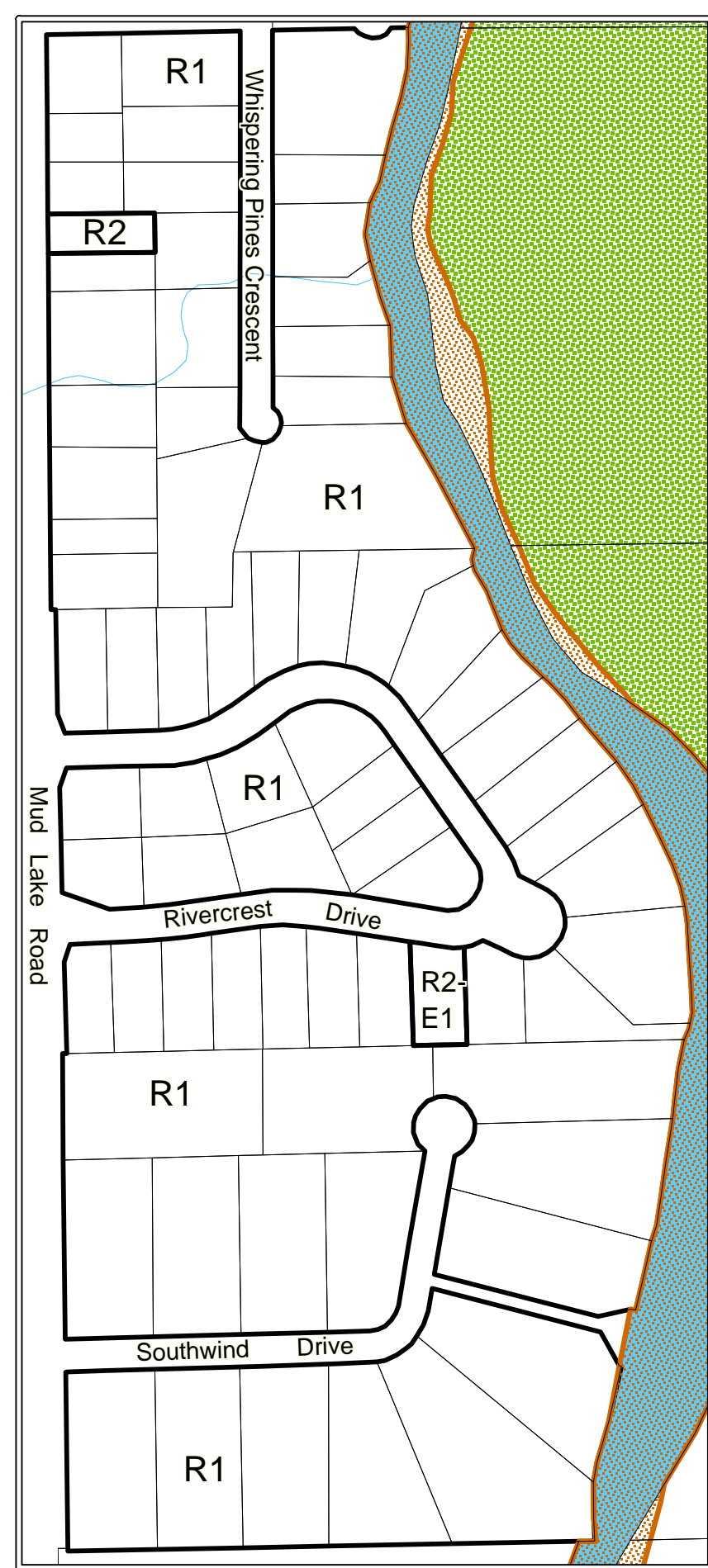

Schedule A-19

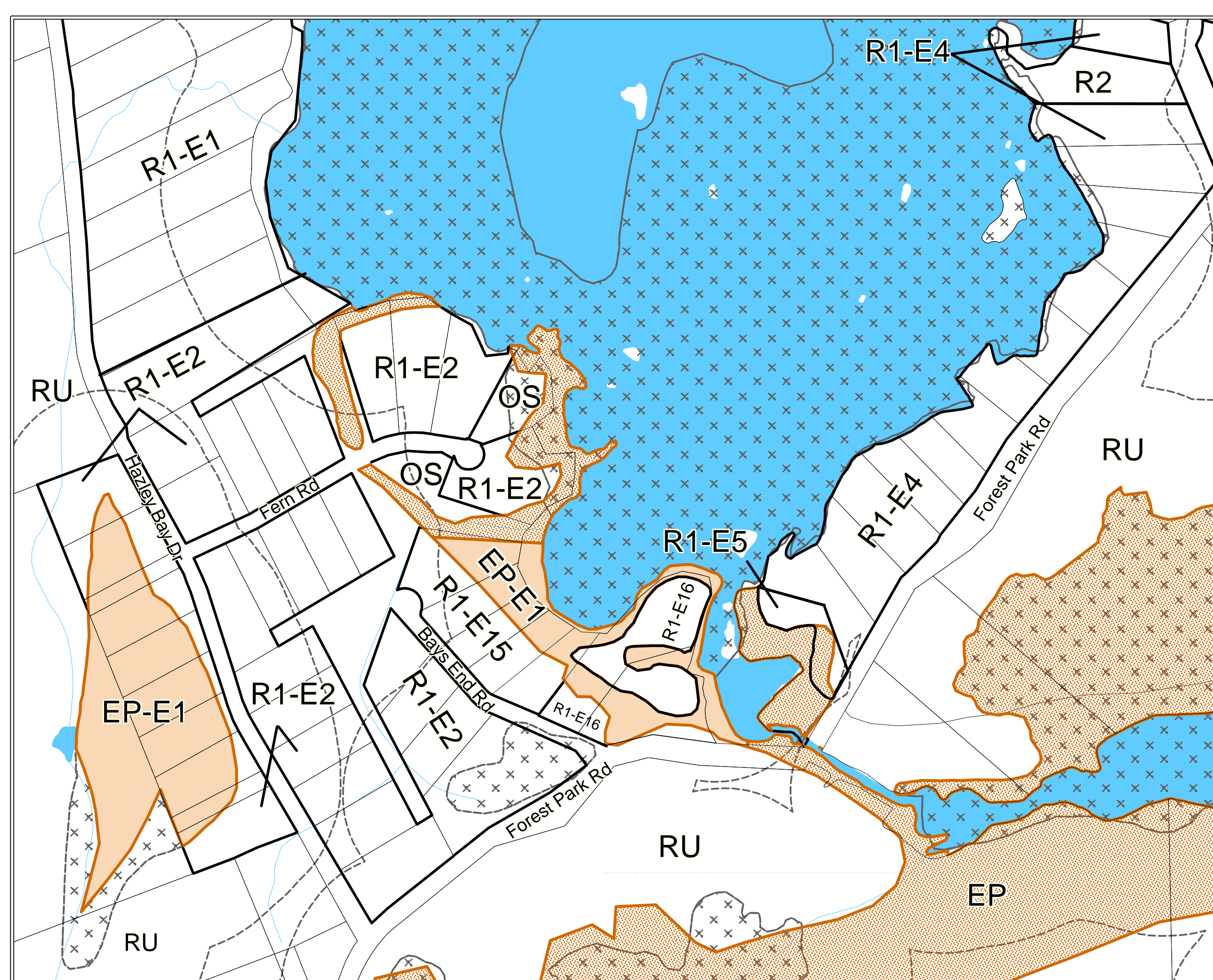

Scale for all Schedules = 1:400

Jp2g Consultants Inc. GeoSolutions Consulting

Legend

	AGRICULTURE (A)		PROVINCIAL HIGHWAY		GEOGRAPHIC TOWNSHIP		ADULT COMMERCIAL		LIGHT INDUSTRIAL		RESIDENTIAL TWO
	ENVIRONMENTAL PROTECTION (EP)		COUNTY ROAD		NATURAL GAS PIPELINE		ARCHEOLOGICAL RESOURCE PROTECTION		HIGHWAY COMMERCIAL		RESIDENTIAL THREE
	MINERAL AGGREGATE RESERVE (EMR)		TOWNSHIP ROAD		HYDRO		COMMUNITY FACILITY		GENERAL COMMERCIAL		RECREATIONAL COMMERCIAL
	CROWN LAND		SEASONAL, PRIVATE or CROWN ROAD		RURAL (RU)		DISPOSAL INDUSTRIAL ONE		SHOPPING CENTRE COMMERCIAL		SUBURBAN RESERVE
	HYDROGRAPHY		RAILWAY		NHF OVERLAY ZONE PROVINCIAL SIGNIFICANT WETLAND (PSW)		DISPOSAL INDUSTRIAL TWO		OPEN SPACE		TOURIST COMMERCIAL
			TOWNSHIP BORDER		120 m BUFFER FROM PSW		EXTRACTIVE INDUSTRIAL		RURAL RESIDENTIAL		URBAN RESERVE
							GENERAL INDUSTRIAL		RESIDENTIAL ONE		LIMITED SERVICE RESIDENTIAL